

ICONIK (F80)

Bifold Door System



The Iconik bifold door system has been engineered to streamline fabrication, simplify stockholding, and accelerate installation without compromising on performance. With slim 87mm interlocks and U-values as low as 1.2 (double glazed single & double door) achieved through advanced seals. Iconik delivers maximum efficiency alongside a modern aesthetic.

Designed for flexibility, the same outerframe and components are used across bifold, single, and double door configurations - requiring only a sash change, one lock, and common cleats across sash and frame mean fewer parts to manage and reduced stockholding.

On-site, Iconik is faster to fit thanks to a 2mm tolerance that removes the need for final panel measurement, while the Quik Clip Bead secures in seconds. The result: a high-performance system that saves time in production, reduces stock complexity, and speeds up every stage of installation. Other key design features include the 110mm mid rail, which allows the creation of transoms with the standard sash.

DESIGN FEATURES

- › Non-Handed Lock and Keep – easier fabrication and installation
- › Optional Shootbolt Locking for larger openings
- › Slim Hinges and Rollers – modern, elegant design
- › High-Capacity Rollers – 130 kg per panel, smooth operation
- › Half-Roller Design – no floating mullion, cleaner appearance

OPTIONS

- › Shootbolt Hardware – for added security
- › Taller Door Capability – for larger openings
- › Thermal Insulation – plastic isolators and glazing foam
- › HI & Standard Insulation Variants – to meet performance needs

SPECIFICATIONS

| Performance* and accreditations | F80 SLIM BIFOLD | F80 STANDARD BIFOLD | F80 STANDARD SINGLE DOOR | F80 STANDARD DOUBLE DOOR |
|---|-----------------------|-----------------------|--------------------------|--------------------------|
| U-Value (Double Glazing) (Ug: 1.0 W/m²K) | 1.3 W/m²K | 1.3 W/m²K | 1.2 W/m²K | 1.2 W/m²K |
| U-Value (Triple Glazing) (Ug: 0.7 W/m²K) | 1.0 W/m²K | 1.0 W/m²K | 0.9 W/m²K | 0.9 W/m²K |
| Air Permeability (Standard Threshold) | Class 2 (300 Pa) | Class 2 (300 Pa) | Class 3 (600 Pa) | Class 3 (600 Pa) |
| Water Tightness (Standard Threshold)* | Class 5a (200 Pa) | Class 5a (200 Pa) | Class 5a (200 Pa) | Class 5a (200 Pa) |
| Wind Resistance | Class A3 (1200 Pa) | Class A3 (1200 Pa) | Class C3 (1200 Pa) | Class C3 (1200 Pa) |
| Security | PAS 24 | PAS 24 | PAS 24 | PAS 24 |
| Cycle Testing Primary Leaf BS 6375 | 50,000 | 50,000 | - | 50,000 |
| Secondary Leaf (10% of Primary) BS 6375-2 | 5,000 | 5,000 | 5,000 | 5,000 |
| System | | | | |
| Depth | 80mm | 80mm | 80mm | 80mm |
| Configurations | | | | |
| Opening | Open-In & Open-Out | Open-In & Open-Out | Open-In & Open-Out | Open-In & Open-Out |
| Size and weight limits | | | | |
| Max Leaf Height | 2400mm std / 3000mm** | 2400mm std / 3000mm** | 2400mm std | 2400mm std |
| Max Leaf Width | 1200mm | 1200mm | 1200mm | 1200mm |
| Max Vent Weight | 130kg | 130kg | 130kg | 130kg |
| Glazing | | | | |
| Glazing Options | Clip Bead | Clip Bead | Clip Bead | Clip Bead |
| Glazing Thickness | 23mm-46mm | 23mm-46mm | 23mm-46mm | 23mm-46mm |
| System Features | | | | |
| Single Colour | ✓ | ✓ | ✓ | ✓ |
| Dual Colour | ✓ | ✓ | ✓ | ✓ |
| Textured Finish | ✓ | ✓ | ✓ | ✓ |
| Anodised Finish | ✓ | ✓ | ✓ | ✓ |
| Multi-Point Locking | ✓ | ✓ | ✓ | ✓ |
| Sightline (Head) | 80mm | 92mm | 92mm | 92mm |
| Sightline (Cill) | 91mm | 92mm | 92mm | - |
| Sightline (Jamb) | 80mm | 92mm | 92mm | 92mm |
| Sightline (Interlock) | 87mm | 110mm | - | - |
| Sightline (Midrail) | - | 110mm | 110mm | 110mm |

CONFIGURATIONS

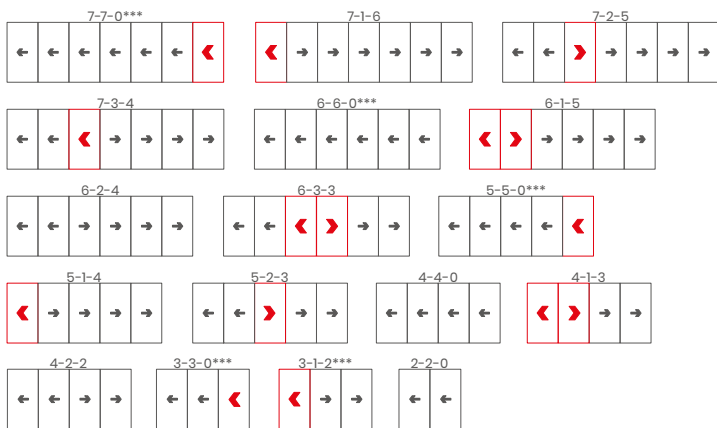

***Opposite handing available on all configurations. For more options, refer to the Technical Manual.

KEY



OTHER OPTIONS AVAILABLE



*Results are based on open in door type.

** Please refer to size limits and span charts for specific configuration limitations. *Results are based on open in door type.

CAD CROSS SECTIONS AND THERMAL PROFILE

Additional details are available on request.

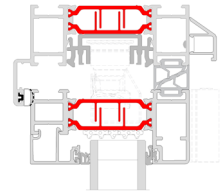

➤ F80 SLIM HEAD

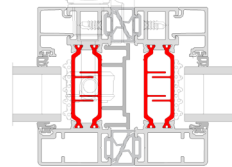

➤ F80 SLIM INTERLOCK

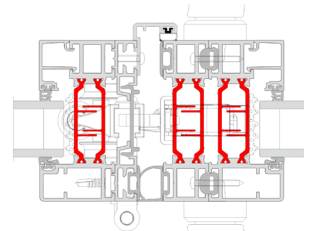

➤ F80 SLIM INTERLOCK - HALF ROLLER

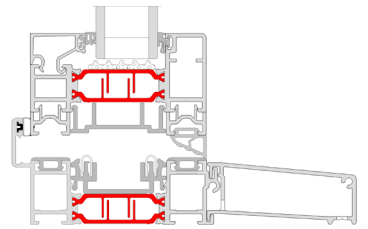

➤ F80 STANDARD FRENCH DOOR

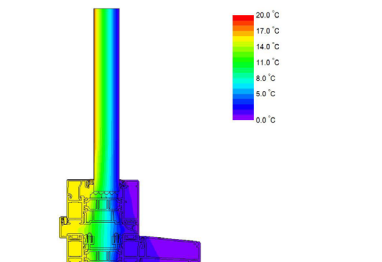

➤ F80 THERMAL PROFILE

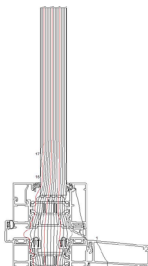

➤ F80 ISOTHERM